

Town of Vestal  
Fire District  
Response Maps

# Town of Vestal Fire District 1-2 Response Map

PREPARED BY



ENGINEERING DEPT.

ACADEMY DR.	D 1	LA GRANGE ST.	C 2
ACORN DR.	H 1	LANDON RD.	E 5
AFRICAN RD.	J 1	LELAND AVE.	B 2
ALPINE DR.	D 2	LEROY AVE.	A 2
ANDERSON DR.	D 7	LEWIS ST.	C 2
ANDREWS RD.	H 2	LINCOLN DR.	D 4
ANNABELLE ST.	A 3	LOREN AVE.	D 2
BROOK HILL AVE.	G 11	LYNDALE DR.	A 3
BROOKLEA DR.	B 2	MAGNOLIA DR.	E 1
BUNN HILL RD.	J 11	MAIN ST.	C 3
BURD DR.	D 6	MARION ST.	A 2
CAROL AVE.	F 8	MARY ST.	C 2
CHARLES ST.	C 1	MEDINA ST.	A 3
CHESTNUT LA.	F 1	MEEKER RD.	G 4
CIRCLE DR.	E 1	MELBOURNE ST.	C 2
CLARK ST.	C 2	MIRADOR DR.	D 2
CLAY ST.	C 2	MOSS RD.	E 5
CLAYTON AVE.	D 1	MOUNTAIN BR DR	J 1
COLONIAL AVE.	C 2	NOYES RD.	B 8
COUNTRYGATE BLVD	C 7	NYS RTE 17	A 1
CROSS RD.	A 6	NYS RTE 26	E 4
DAVID AVE.	F 8	NYS RTE 434	B 1
DELANO AVE.	D 2	PICKWICK DR.	D 2
DORIS AVE.	A 2	PIERCE HILL RD.	F 2
ECHO RD.	B 5	PUMPHOUSE RD.	B 1
ELIZABETH ST.	B 2	RAIFORD RD.	D 4
ELMHAVEN DR.	B 2	RED FOX LA.	E 1
ETHEL PL.	A 2	REDWOOD LA.	E 1
FORD RD.	D 4	RIDGEWOOD AV	C 2
FOSTER RD.	H 6	RITA RD.	E 7
FREY AVE.	B 2	ROBERT ST.	B 1
FRONT ST.	B 1	SANDY DR.	F 8
GARY DR.	G 8	SEQUOIA LA.	E 1
GEORGE ST.	C 2	SHEEDY RD.	H 7
GLENWOOD RD.	E 6	SKYLINE DR.	G 1
GREEN BRIAR CT.	J 1	SUSAN CT.	F 8
GRIPPEN HILL RD.	E 8	TORRANCE AVE.	A 2
HARDING AVE.	A 2	TOWN HALL RD	A 2
HAWTHORNE ST.	C 2	VANDERVORT AV	C 1
HAZEL DR.	C 2	VERNA DR.	A 3
HEMLOCK LA.	H 1	VESTAL PKWY. E.	A 1
IRVING PL.	A 2	VIRGINIA AV.	B 2
JODIE DR.	C 5	WILLARD AVE.	C 2
JONES RD.	C 6	WILLOW ST.	B 2
JUNEBERRY RD.	E 7	WINSTON DR.	A 3
KARIN AVE.	D 2	WOODGATE LA.	G 7
KATHERINE LA.	C 2	WOODLAWN DR.	D 1
KEENAN DR.	D 2		
KIMBLE RD.	B 1		
KNIGHT RD.	B 7		

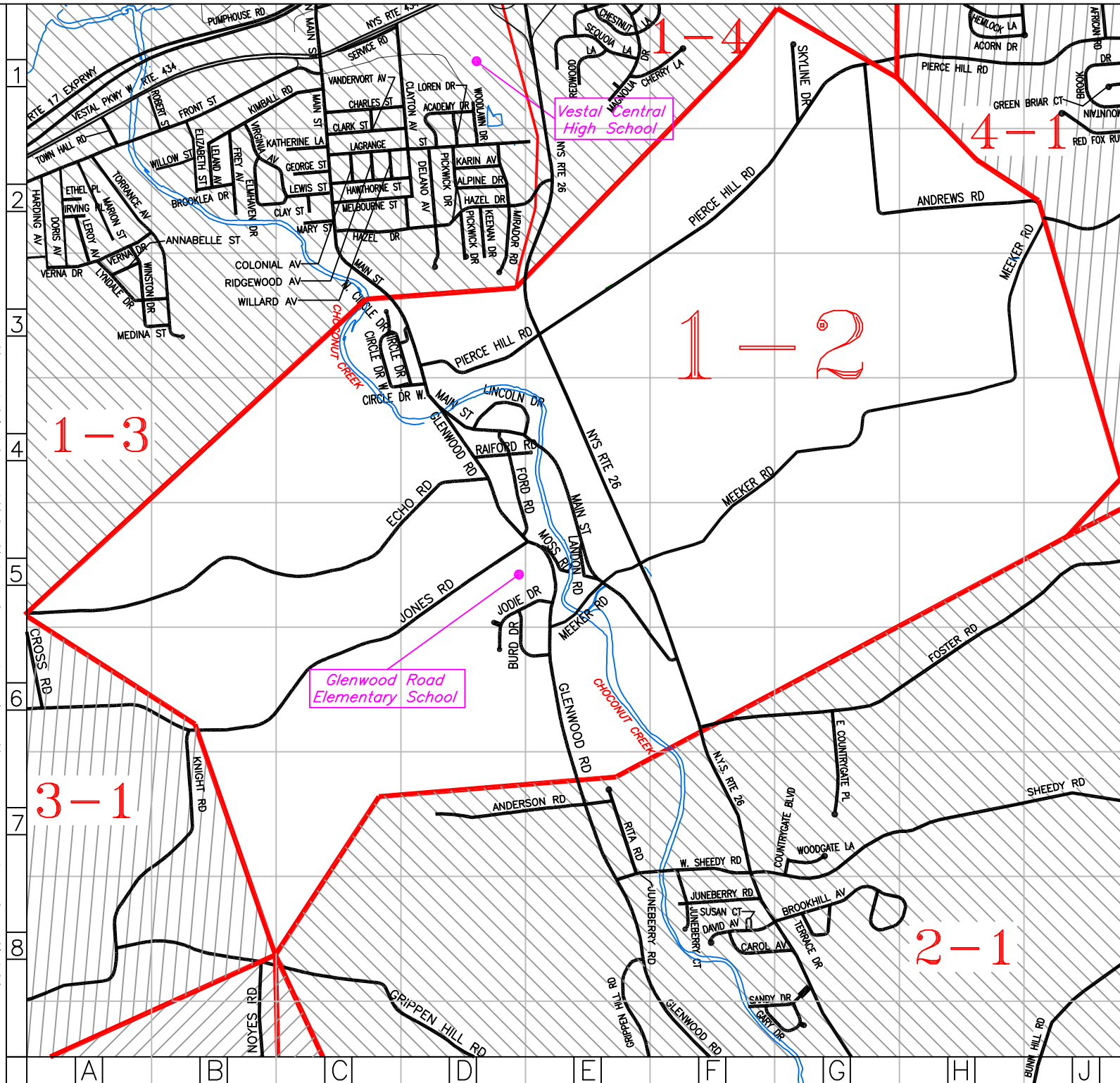

ACADEMY DR.	K 7	LELAND AVE.	H 7
AIRBORNE AVE.	L 6	LEROY AVE.	G 8
ALPINE DR.	K 8	LEWIS ST.	J 8
ANNABELLE ST.	H 8	LINCOLN DR.	L 9
ARCH DR.	F 8	LOREN AVE.	K 7
BROOKLEA DR.	H 8	LORETTA LA.	E 8
BURD DR.	L 11	LYNDALE DR.	G 8
BUTTERNUT DR.	E 9	MAGNOLIA DR.	M 6
CASTLE GARDENS RD.	E 8	MAIN ST.	J 6
CHARLES ST.	J 7	MARION ST.	G 8
CHESTNUT LA.	M 6	MARY ST.	J 8
CIRCLE DR.	K 9	MEADOW LA.	E 8
CLARK ST.	J 7	MEDINA ST.	H 9
CLAY ST.	J 8	MEEKER RD.	M 10
CLAYTON AVE.	K 7	MELBOURNE ST.	J 8
COLONIAL AVE.	J 7	MIRADOR DR.	L 8
DELANO AVE.	K 8	MOSS RD.	L 11
DORIS AVE.	G 8	NYS RTE 17	A 10
ECHO RD.	D 11	NYS RTE 26	K 4
EDGEWOOD RD.	F 8	NYS RTE 434	V 4
ELDREDGE DR.	J 5	PARKWOOD RD.	F 8
ELIZABETH ST.	H 7	PICKWICK DR.	K 8
ELMHAVEN DR.	J 8	PIERCE HILL RD.	L 9
ETHEL PL.	G 8	PUMPHOUSE RD.	J 6
FORD RD.	L 10	RAIFORD RD.	K 10
FREY AVE.	H 7	REDWOOD LA.	L 7
FRONT ST.	J 7	REESE AVE.	F 8
GEORGE ST.	J 8	RIDGEWOOD AVE.	J 7
GLENWOOD RD.	K 10	RIVER RD.	L 5
HARDING AVE.	G 8	ROBERT ST.	H 7
HAWTHORNE ST.	J 8	SEQUOIA LA.	L 7
HAZEL DR.	J 8	SEYMOUR RD.	F 8
HILLSIDE DR.	F 8	STAGE RD.	E 6
HOFFMAN AVE.	G 8	(N) STAGE RD.	E 6
IDEAL TERRACE	L 5	TORRANCE AVE.	H 8
IMPERIAL CT.	L 6	TOWN HALL RD.	B 10
IMPERIAL WOODS DR.	L 6	VANDERVORT AVE.	J 7
IRVING PL.	G 8	VERNA DR.	G 8
JANE ST.	L 5	VESTAL PKWY. E.	J 7
JODIE DR.	L 11	VESTAL PKWY W.	H 7
JONES RD.	L 13	VESTAL ROAD	J 5
KARIN AVE.	K 7	VIRGINIA AVE.	J 8
KATHERINE LA.	J 7	VIVIAN LA.	E 8
KEENAN DR.	K 8	WILLARD AVE.	K 7
KIMBLE RD.	J 7	WILLOW ST.	H 7
LA GRANGE ST.	K 7	WINSTON DR.	H 8
LONDON RD.	L 11	WOODLAWN DR.	K 7
		WRIGHT RD.	F 8

# Town of Vestal Fire District 1-3 Response Map

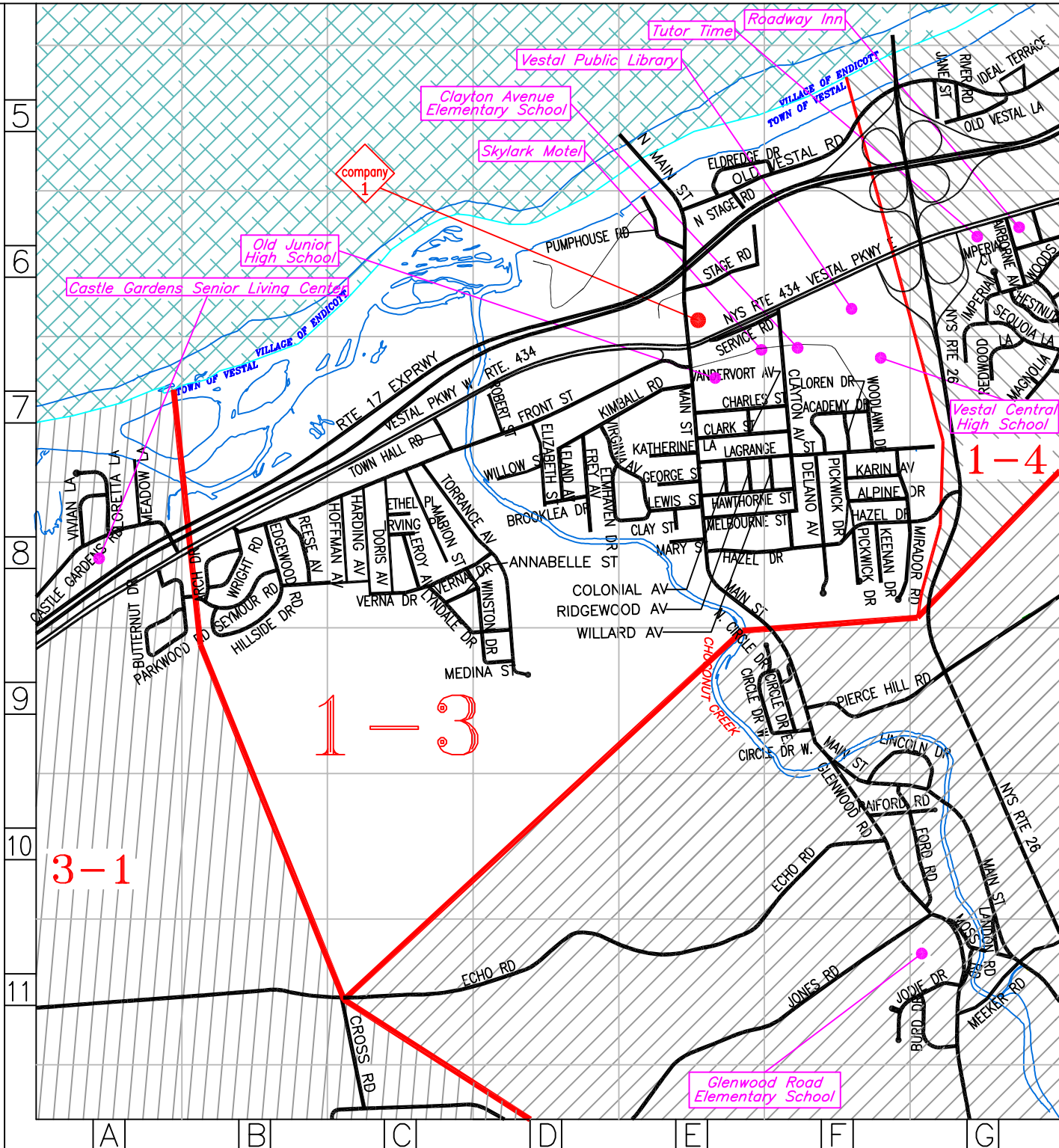

# Town of Vestal Fire District 1-4 Response Map

PREPARED BY



ENGINEERING DEPT.

ACADEMY DR.	A 6	LOREN AVE.	A 5
ACORN DR.	E 4	LOUELLA ST.	D 3
AFRICAN RD.	E 3	MAGNOLIA DR.	B 5
AIRBORNE AVE.	B 4	MAPLE ST.	D 3
ALPINE DR.	A 6	MEEKER RD.	E 6
ANDREWS RD.	D 6	MOUNTAIN BR DR.	F 5
AYRES CT.	D 4	MYRTLE ST.	D 3
BEECHWOOD LA.	B 4	NYS RTE 17	B 3
BENITA BLVD.	E 4	NYS RTE 26	A 5
BIRCH ST.	D 3	NYS RTE 434	C 3
BRADY AVE.	B 4	OAK ST.	D 3
BROOKS AVE.	D 3	ORCHARD ST.	D 2
CEDAR ST.	D 2	PEARL ST.	C 2
CHARLESTON AVE.	F 3	PICKWICK DR.	A 6
CHERRY LA.	B 5	PIERCE HILL RD.	C 6
CHESTNUT LA.	B 4	PLEASANT DR.	D 4
CLOVER DR.	D 4	RED FOX RUN	F 5
CRESCENT LA.	F 4	REDWOOD LA.	B 5
DEBRA DR.	D 4	RIDGEHAVEN DR.	D 3
DONNA DR.	E 3	RIVER RD.	A 3
EDWARD ST.	B 2	RODGER AVE.	B 4
ELM ST.	D 2	SECOND AVE.	C 3
FIRST AVE.	C 3	SEQUOIA LA.	B 4
FOURTH AVE.	C 2	SKYLINE DR.	C 5
GREEN BRIAR CT.	F 5	TAMARACK LN.	D 4
HAZEL DR.	A 6	THIRD AVE.	C 3
HEMLOCK LA.	E 4	VALLEY RD.	C 3
HIGH AVE.	F 3	VESTAL PKWY. E.	D 3
HOLBERT AVE.	D 3	VESTAL ROAD	E 2
HOLLY HILL RD	F 4	WAKEMAN RD.	E 3
IDEAL TERRACE	B 3	WALNUT ST.	D 3
IMPERIAL CT.	B 4	WALTER L RD.	B 4
IMPERIAL WOODS DR.	B 4	WARREN ST.	D 4
JANE ST.	A 3	WILLIAM ST.	D 4
KARIN AVE.	A 5	WINANS AVE.	B 2
KEENAN DR.	A 6	WOODLAWN DR.	A 5
KING ST.	D 3		

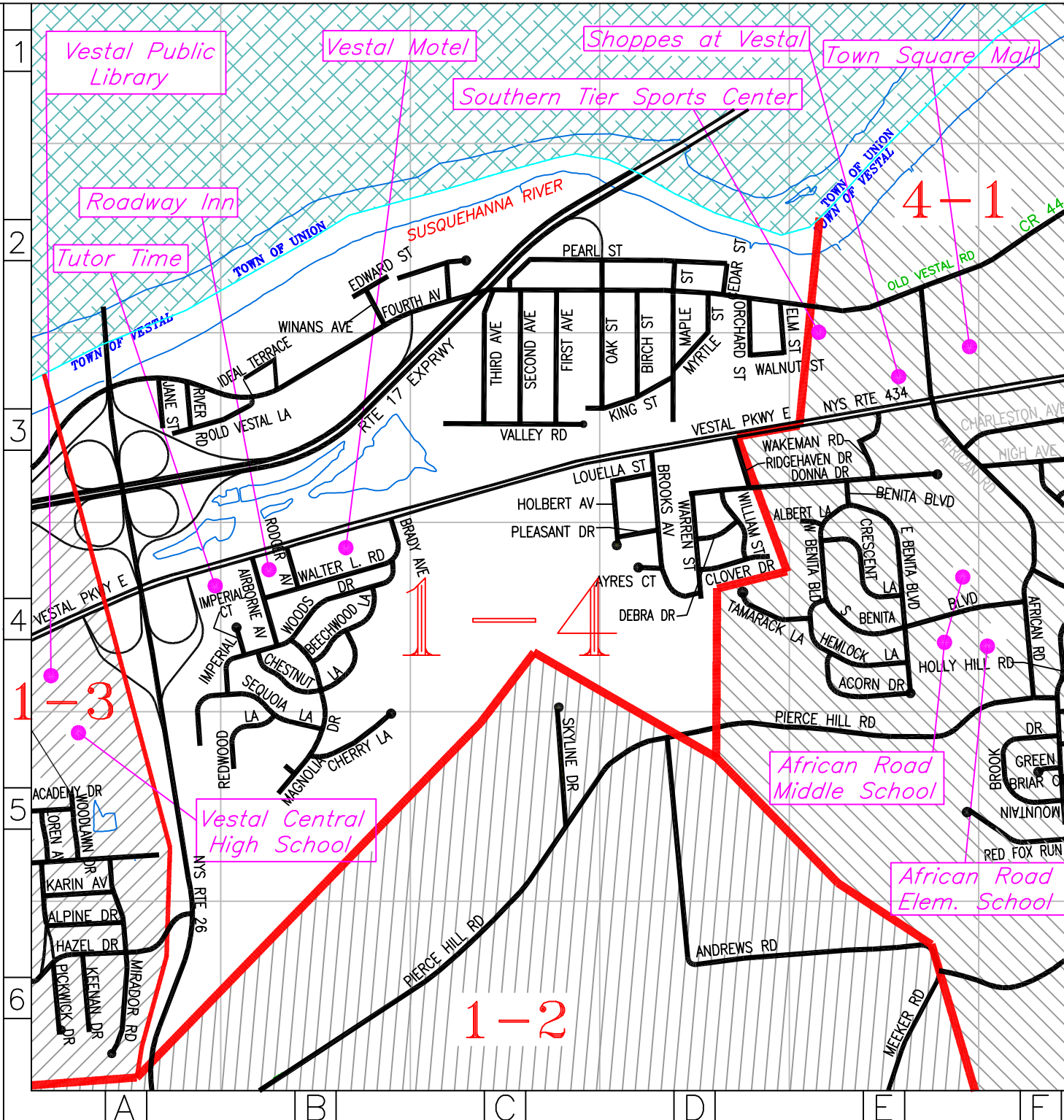

ANDERSON RD.  
 BROOK HILL AVE.  
 BROWN RD.  
 BUNN HILL RD. E.  
 BURD DR.  
 CAMERON LA.  
 CAMPUS DR.  
 CARNEGIE DR.  
 CAROL AVE.  
 CASTLEMAN RD.  
 COLE PL.  
 COLEMAN ST.  
 COSTLEY RD.  
 COUNTRYGATE BLVD  
 DAVID AVE.  
 DREXEL DR.  
 EAST COUNTRYGATE PL.  
 ECHO RD.  
 EMERSON PL.  
 FOLEY RD.  
 FORD RD.  
 FOSTER RD.  
 FRANKLIN PL.  
 FULLER HOLLOW RD.  
 GALAXY DR.  
 GARDENER RD.  
 GARY DR.  
 GLENWOOD RD.  
 GRAND AVE.  
 GRIPPEN HILL RD.  
 HANCE RD.  
 HAMILTON PL.  
 HAWLEYTON TRNPKE  
 HOGAN RD.  
 HORAN RD.  
 HORSESHOE LA.  
 JENSEN RD.  
 JODIE DR.  
 JONES RD.  
 JUNE BERRY CT.  
 JUNE BERRY RD.  
 KANE DR.  
 KATHLEEN DR.  
 KILMER RD.  
 LONDON RD.  
 LAURA LA.  
 LINCOLN DR.  
 LIVINGSTON PL.  
 MAIN ST.  
 MARIETTA DR.  
 MAXIAN RD.  
 MEEKER RD.  
 MOSS RD.  
 NELSON RD.  
 NOYES RD.  
 NYS RTE 26  
 PARK AVE.  
 POWDERHOUSE RD.  
 RAIFORD RD.  
 RAYLENE DR.  
 RICHARDS AVE.  
 RIDGE RD.  
 RITA RD.  
 ROCK RD. N.  
 ROCK RD. S.  
 SANDY DR.  
 SIENA LA.  
 SHEEDY RD.  
 STATE LINE RD.  
 STILES RD.  
 SUNSET AVE.  
 SUSAN CT.  
 TERRACE DR.  
 THARP ST.  
 UNDERWOOD RD.  
 WAY ST.  
 WEST HILL RD.  
 W SHEEDY RD.  
 WOODGATE LA.

B 5  
 E N 5  
 K 3  
 C 4  
 O 2  
 P 2  
 P 3  
 C 6  
 D 7  
 F 13  
 F 9  
 D 5  
 D 6  
 O 3  
 E 4  
 A 3  
 P 2  
 O 6  
 C 2  
 F 3  
 O 2  
 N 1  
 F 7  
 K 8  
 E 6  
 G 11  
 F 9  
 B 6  
 P 14  
 P 3  
 P 16  
 O 5  
 M 4  
 E 8  
 K 1  
 C 3  
 B 3  
 D 5  
 D 5  
 D 7  
 E 19  
 D 8  
 C 3  
 F 9  
 C 1  
 D 2  
 C 2  
 P 2  
 P 11  
 E 2  
 C 3  
 D 12  
 A 7  
 E 8  
 F 9  
 H 8  
 B 2  
 D 8  
 J 14  
 A 12  
 D 5  
 H 6  
 G 8  
 E 6  
 P 1  
 G 5  
 N 16  
 L 14  
 F 9  
 E 6  
 E 6  
 J 15  
 D 15  
 G 9  
 E 10  
 D 5  
 E 5

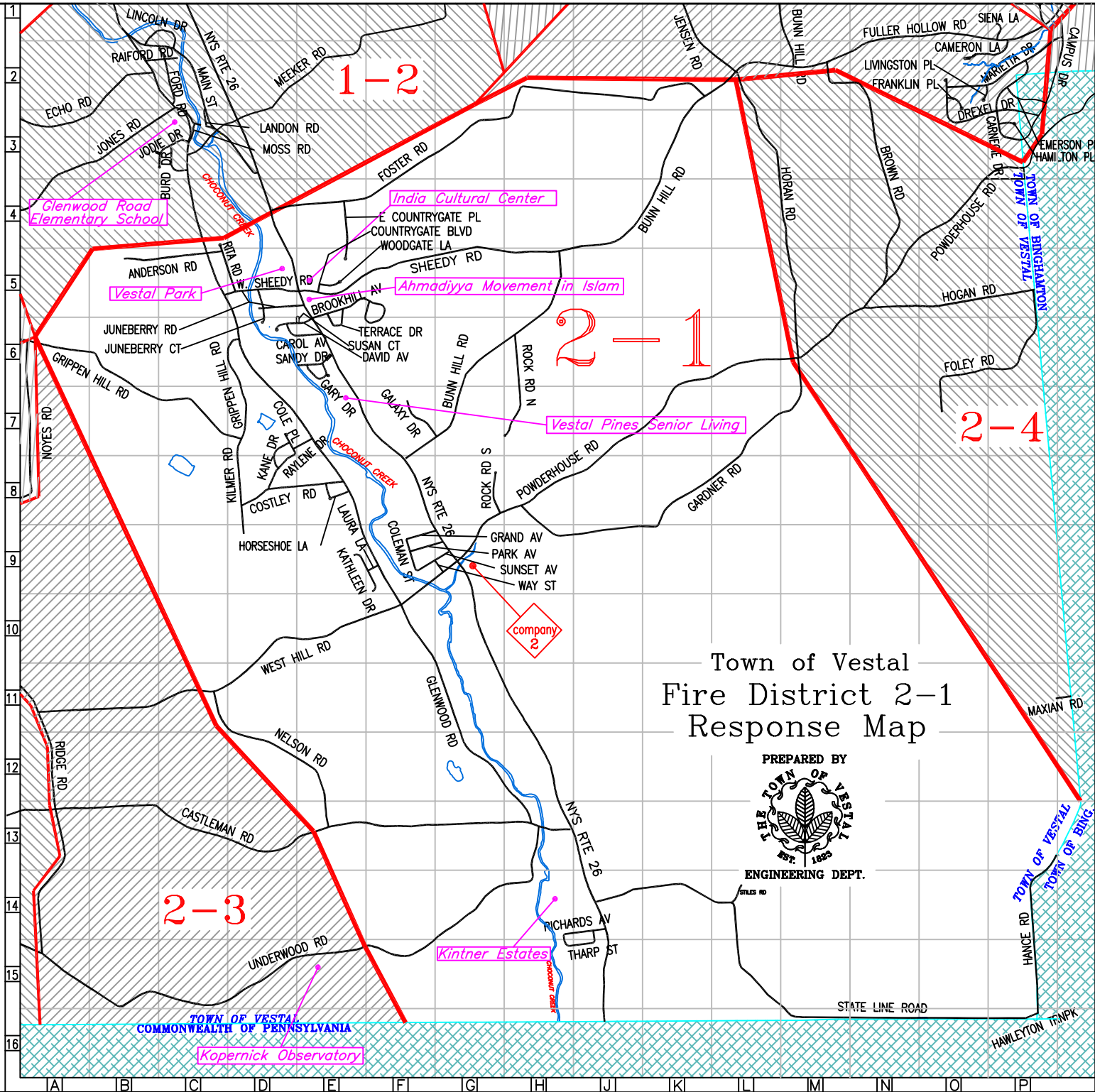

# Town of Vestal Fire District 2-3 Response Map

PREPARED BY



ENGINEERING DEPT.

BROOK HILL AVE.	H	1
BUNN HILL RD. E.	K	3
CAROL AVE.	H	2
CASTLEMAN RD.	F	9
COLE PL.	G	3
COLEMAN ST.	J	5
COSTLEY RD.	G	4
DAVID AVE.	G	2
GALAXY DR.	J	3
GARDNER RD.	L	4
GARY DR.	H	2
GLENWOOD RD.	K	7
GRAND AVE.	J	5
GRIPPEN HILL RD.	E	2
HORSESHOE LA.	H	4
JUNEBERRY CT.	G	1
JUNEBERRY RD.	G	1
KANE DR.	G	4
KATHLEEN DR.	H	5
KILMER RD.	G	4
KNIGHT RD.	A	2
LAURA LA.	J	5
NELSON RD.	G	8
NOYES RD.	C	4
NYS RTE 26	L	8
O'CONNELL RD.	A	10
PARK AVE.	J	5
PLOUGH RD.	C	7
POWDERHOUSE RD.	L	4
RAYLENE DR.	G	4
RICHARDS AVE.	L	10
RIDGE RD.	B	4
RITA RD.	G	1
SANDY DR.	H	2
SUNSET AVE.	J	5
SUSAN CT.	G	1
TERRACE DR.	H	2
THARP ST.	L	11
UNDERWOOD RD.	D	11
WAY ST.	K	5
WEST HILL RD.	E	7
WOODGATE LA.	H	1
WORRICK POND RD.	C	11

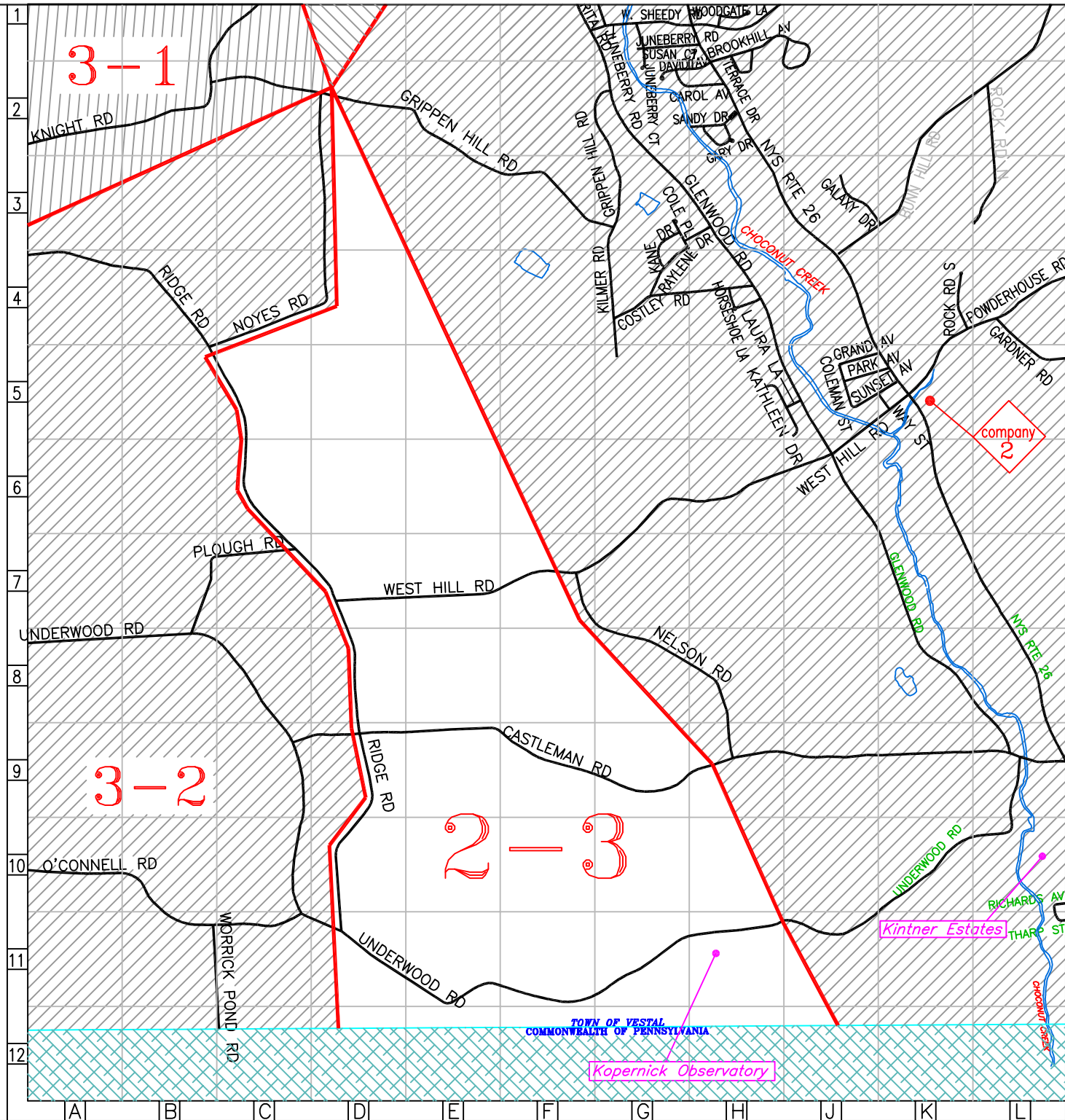

# Town of Vestal Fire District 2-4 Response Map

PREPARED BY



ENGINEERING DEPT.

- |                   |      |
|-------------------|------|
| BROWN RD.         | C 3  |
| BUNN HILL RD. E.  | G 2  |
| CAMERON LA.       | J 1  |
| CAMPUS DR.        | J 1  |
| CARNEGIE DR.      | J 2  |
| CASTLEMAN RD.     | A 12 |
| DREXEL DR.        | H 2  |
| EMERSON PL.       | J 1  |
| FOLEY RD.         | H 5  |
| FOSTER RD.        | C 1  |
| FRANKLIN PL.      | F 1  |
| FULLER HOLLOW RD. | H 1  |
| GARDNER RD.       | D 7  |
| GLENWOOD RD.      | A 10 |
| HAMILTON PL.      | J 2  |
| HOGAN RD.         | H 4  |
| HORAN RD.         | F 3  |
| JENSEN RD.        | D 1  |
| LIVINGSTON PL.    | H 1  |
| MARIETTA DR.      | J 1  |
| MAXIAN RD.        | K 10 |
| NYS RTE 26        | B 11 |
| POWDERHOUSE RD.   | D 6  |
| ROCK RD. N.       | A 7  |
| ROCK RD. S.       | B 5  |
| SHEEDY RD.        | A 3  |
| WEST HILL RD.     | A 8  |

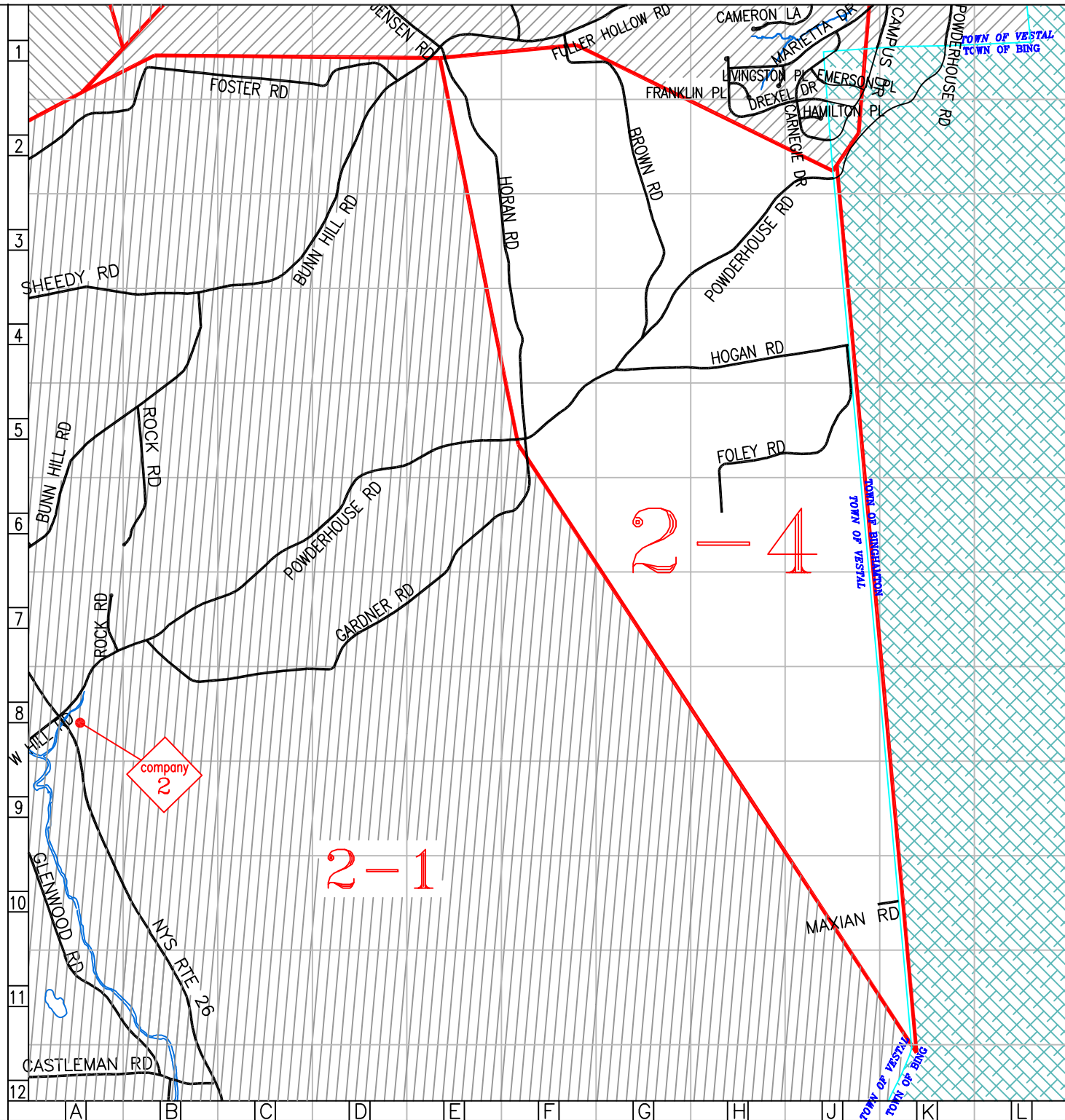

# Town of Vestal Fire District 3-1 Response Map

PREPARED BY



ENGINEERING DEPT.

ALDRICH DR.  
ANNABELLE ST.  
ARBOR PL.  
ARCH DR.  
ARLINGTON AVE.  
AVELON CT.  
CASTLE GARDENS RD.  
CEDARWOOD DR.  
CLIFFORD DR.  
CREST ST.  
CROSS RD.  
CULVER PKWY.  
DORIS AVE.  
EASTLAND RD.  
ECHO RD.  
EDGEWOOD RD.  
ELIZABETH ST.  
ETHEL PL.  
FAIRVIEW AVE.  
GARDEN LA.  
GREEN LAWN RD.  
GRIPPEN HILL RD.  
HARDING AVE.  
HILLSIDE DR.  
HOFFMAN AVE.  
IRVING PL.  
JONES RD.  
KNIGHT RD.  
LEROY AVE.  
LORETTA LA.  
LYNDALE DR.  
MARION ST.  
MEADOW LA.  
MEDINA ST.  
MIDLAND AVE.  
NORRIS AVE.  
NORTH RD.  
NYS RTE 17  
NYS RTE 434  
OWEGO RD.  
PARKWOOD RD.  
REESE AVE.  
ROCKWELL RD.  
ROSS HILL RD.  
SEYMOUR RD.  
TORRANCE AVE.  
TRACY CREEK RD.  
VERNA DR.  
VESTAL PKWY W.  
VIVIAN LA.  
WESTLAND RD.  
WESTVIEW DR.  
WILLOW ST.  
WINSTON DR.  
WRIGHT RD.

B 4  
C 1  
D 1  
E 1  
F 3  
G 4  
H 1  
I 1  
J 1  
K 1  
L 1  
M 1  
N 1  
O 1  
P 1  
Q 1  
R 1  
S 1  
T 1  
U 1  
V 1  
W 1  
X 1  
Y 1  
Z 1  
AA 1  
BB 1  
CC 1  
DD 1  
EE 1  
FF 1  
GG 1  
HH 1  
II 1  
JJ 1  
KK 1  
LL 1  
MM 1  
NN 1  
OO 1  
PP 1  
QQ 1  
RR 1  
SS 1  
TT 1  
UU 1  
VV 1  
WW 1  
XX 1  
YY 1  
ZZ 1  
AAA 1  
BBB 1  
CCC 1  
DDD 1  
EEE 1  
FFF 1  
GGG 1  
HHH 1  
III 1  
JJJ 1  
KKK 1  
LLL 1  
MMM 1  
NNN 1  
OOO 1  
PPP 1  
QQQ 1  
RRR 1  
SSS 1  
TTT 1  
UUU 1  
VVV 1  
WWW 1  
XXX 1  
YYY 1  
ZZZ 1  
AAA 1  
BBB 1  
CCC 1  
DDD 1  
EEE 1  
FFF 1  
GGG 1  
HHH 1  
III 1  
JJJ 1  
KKK 1  
LLL 1  
MMM 1  
NNN 1  
OOO 1  
PPP 1  
QQQ 1  
RRR 1  
SSS 1  
TTT 1  
UUU 1  
VVV 1  
WWW 1  
XXX 1  
YYY 1  
ZZZ 1

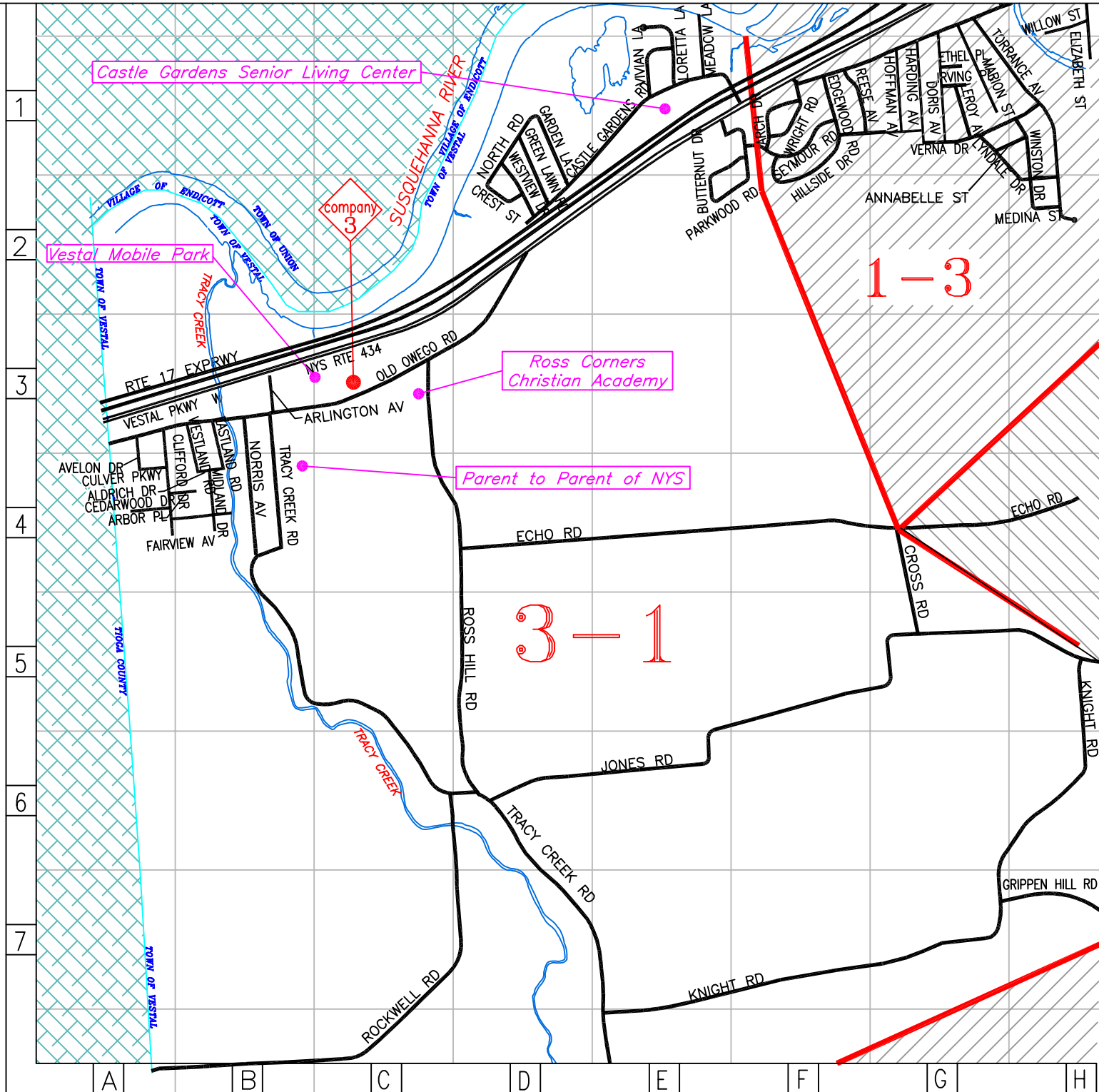



# Town of Vestal Fire District 3-2 Response Map



BAKER HILL RD.	D 5
CASTLEMAN RD.	H 9
COLLINS RD.	D 11
CRUMM RD.	D 8
GRIPPEN HILL RD.	H 2
KNIGHT RD.	E 2
MASON RD.	C 7
NOYES RD.	G 3
O'CONNELL RD.	F 10
PLOUGH RD.	H 7
RIDGE RD.	F 4
ROCKWELL RD.	C 3
TRACY CREEK RD.	E 7
WEST HILL RD.	G 7
WORRICK POND RD.	H 11

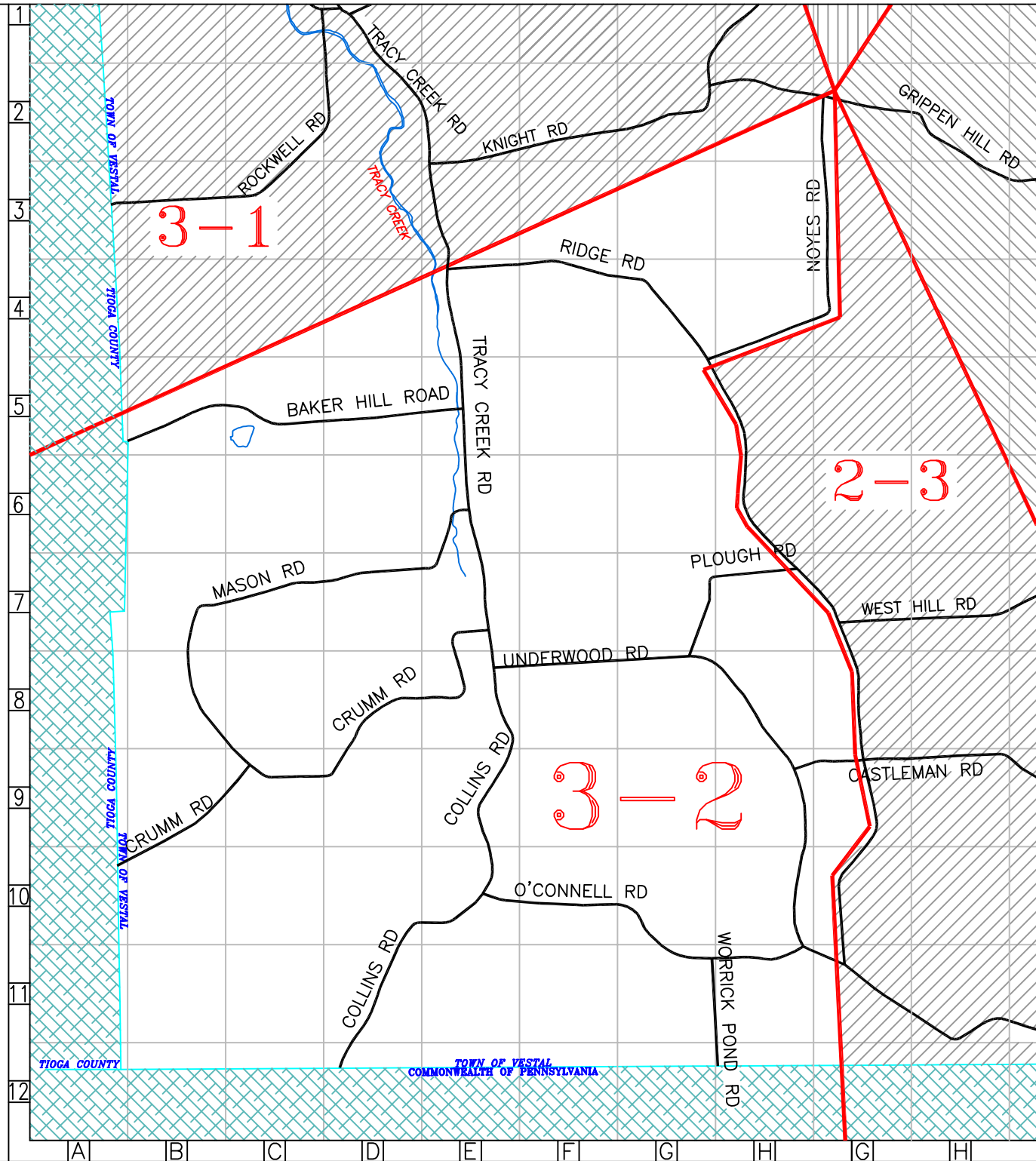

ACKERMAN RD.	D 3	DODD RD.	G 5	MARTHA RD.	H 4	SIENA LA.	L 8
ACORN DR.	B 5	DONNA DR.	B 4	Mc LAIN RD.	E 2	SHIPPERS RD	D 3
AFRICAN RD.	C 4	DUKE DR.	M 6	MEADOWBROOK LA.	G 3	SKYLINE DR.	A 6
ALBERT LA.	B 5			MEEKER RD.	B 8	SOUTHWOOD DR.	F 4
ALICE ST.	F 3	EARL RD.	F 3	MERCER PL.	L 5	STAMFORD	D 5
ALMAR DR.	F 5	ELM ST.	B 3	MICHAEL ST.	E 6	STEWART RD.	E 3
AMHERST AVE.	M 7	ELSMERE PL.	M 6	MIDVALE RD.	L 6	STONEHEDGE DR.	D 5
ANDREA DR.(private)	G 3	EMERSON PL.	L 9	MOUNTAIN BROOK DR.	C 6	STRATFORD DR.	F 3
ANDREWS RD.	B 7	EMILY CT.	E 6	MURRAY HILL RD.	L 5	SUNRISE PL.	F 5
ANNETTA ST.	H 4	EVERGREEN ST.	D 4	MYRTLE ST.	B 4	SYCAMORE RD.	D 3
ASH RD.	D 3						
AUDUBON RD.	N 5	FIRST AVE.	A 4	NYS RTE 17	A 3	TAMARACK LN.	B 5
AVONDALE DR.	H 4	FORDHAM RD.	D 4	NYS RTE 201	J 3	TAYLOR DR.	M 6
AYRES CT.	A 5	FOREST LA.	L 5	NYS RTE 434	B 4	THIRD AVE.	A 4
		FOSTER RD.	E 6			TULANE ST.	E 5
BAY ST.	N 6	FOXWOOD LA.	D 6	OAK ST.	A 4		
BAYBERRY LA.	D 5	FRANKLIN PL.	K 9	OAK HOLLOW RD.	D 6	UNIVERSITY CT.	H 6
BAYLOR DR.	M 7	FULLER HOLLOW RD.	J 8	O'HARA DR.	J 3		
BELMONT AVE.	E 4			OLD LANE RD.	J 2	VALLEY RD.	A 4
BENITA BLVD.	B 5	GATES RD.	G 2	OLD MILL RD.	K 3	VESTAL PKWY. E.	B 4
BIRCH ST.	A 4	GREEN BRIAR CT.	C 6	ORCHARD ST.	B 4	VESTAL ROAD	G 3
BRENTWOOD PL.	F 3			OVERBROOK DR.	D 6		
BRIARCLIFF AVE.	E 5	HARTWICK DR.	L 8	OXFORD PL.	L 4	WAKEMAN RD.	B 4
BRIARVIEW PL.	F 5	HARVARD ST.	E 9	OZALID RD.	D 4	WALNUT ST.	B 4
BROOKS AVE.	A 4	HARWOOD DR.	E 5			WARREN ST.	B 5
BUNN HILL RD. W.	B 5	HEMLOCK LA.	B 5	PEARL ST.	A 3	WASHINGTON DR.	L 6
BURRIS RD.	E 5	HIGH AVE.	C 4	PEMBROOKE LA.	H 2	WILDWOOD LA.	M 8
		HIGHLAND DR.	G 4	PIERCE HILL RD.	B 6	WILLIAM ST.	B 5
CAMBRIDGE PL.	L 8	HOLBERT AVE.	A 4	PINE MEADOW LA.	D 6	WINDING LA.	H 5
CAMERON LA.	K 9	HOLLY HILL RD.	D 6	PINEBLUFF DR.	D 5	WOODBERRY DR.	E 5
CAMPUS DR.	M 8			PINECREST RD.	G 2	WOODS RD.	J 2
CASE DR.	M 6	JENSEN RD.	F 8	PLAZA DR.	M 4		
CEDAR ST.	B 3			PLEASANT DR.	A 5		
CHALBURN RD.	F 4	KING ST.	A 4	POWDERHOUSE RD.	M 7		
CHARLESTON AVE.	C 4	KNAPP RD.	E 6	PRATT DR.	L 6		
CLARKSON DR.	D 5			PRENTICE RD.	E 1		
CLIFTON BVLD.	N 5	LAUDERDALE DR.	H 4	PRINCETON DR.	D 5		
CLOVER DR.	B 5	LEHIGH AVE.	L 6	PURDUE DR.	D 5		
CLUBHOUSE RD.	M 5	LENNOX AVE.	N 4				
COLGATE ST.	E 5	LIVINGSTON PL.	K 9	QUEENSBURY CT.	G 2		
COMMERCE RD.	G 1	LOUELLA ST.	A 4				
CORNELL AVE.	E 5	LYNNHURST DR.	D 5	RADCLIFF BVLD.	L 7		
CORTLAND DR.	E 5	LYNWOOD PL.	F 2	RANO BVLD.	D 4		
COUNTRY CLUB RD.	M 6			RED FOX LA.	C 6		
CRESCENT LA.	B 5	MADISON DR.	M 7	RHONDA DR.	D 4		
		MANCHESTER RD.	L 4	RIDGEHAVEN DR.	B 4		
		MANSFIELD RD.	L 4	ROBIN LA.	D 5		
		MAPLE ST.	A 4	ROYAL ST.	E 4		
		MAPLECREST DR.	F 3				
DARTMOUTH DR.	D 5	MARGUERITE CT.	M 7	SADDLEBROOK DR.	D 5		
DEBRA DR.	B 5	MARIETTA DR.	L 9	SALEM DR.	M 7		
DEERFIELD PL.	M 5	MARK CT.	E 6	SALLY DR.	E 6		
DELLWOOD RD.	N 5	MARLBORO PL.	L 4	SARASOTA AVE.	E 5		
DENAL WAY	F 5	MARSHALL DR. E	N 6	SCHUBMEHL RD.	F 3		
DIANA LA.	F 5	MARSHALL DR. W	M 7	SECOND AVE.	A 4		
DICKINSON DR.	L 6						

### POINTS OF INTEREST

AFRICAN ROAD ELEMENTARY SCHOOL	B 6
AFRICAN ROAD MIDDLE SCHOOL	B 6
VESTAL HILLS ELEMENTARY SCHOOL	K 6
BINGHAMTON UNIVERSITY	K 5
CAMPUS PLAZA	H 3
JEWISH COMMUNITY CENTER	J 4
SOUTHERN TIER SPORTS CENTER	A 2
TEMPLE ISREAL	K 5
TOWN SQUARE THEATRE	B 2
WILLOW POINT NURSING CENTER	H 2
EMERITUS WOODLAND MANOR	K 5
EMERITUS AT VESTAL HILLS	M 4
HAMPTON INN	G 4
QUALITY INN	K 4
HOLIDAY INN EXPRESS	G 4
HOMWOOD SUITES	G 4
CANDLEWOOD SUITES	G 4
MARRIOTT INN	H 3
PARKWAY PLAZA	D 1
RESIDENCE INN	L 3
SHOPPES AT VESTAL	B 2
TOWN SQUARE MALL	B 2
UNIVERSITY PLAZA	M 3

# Town of Vestal Fire District 4-1 Response Map

PREPARED BY



ENGINEERING DEPT.

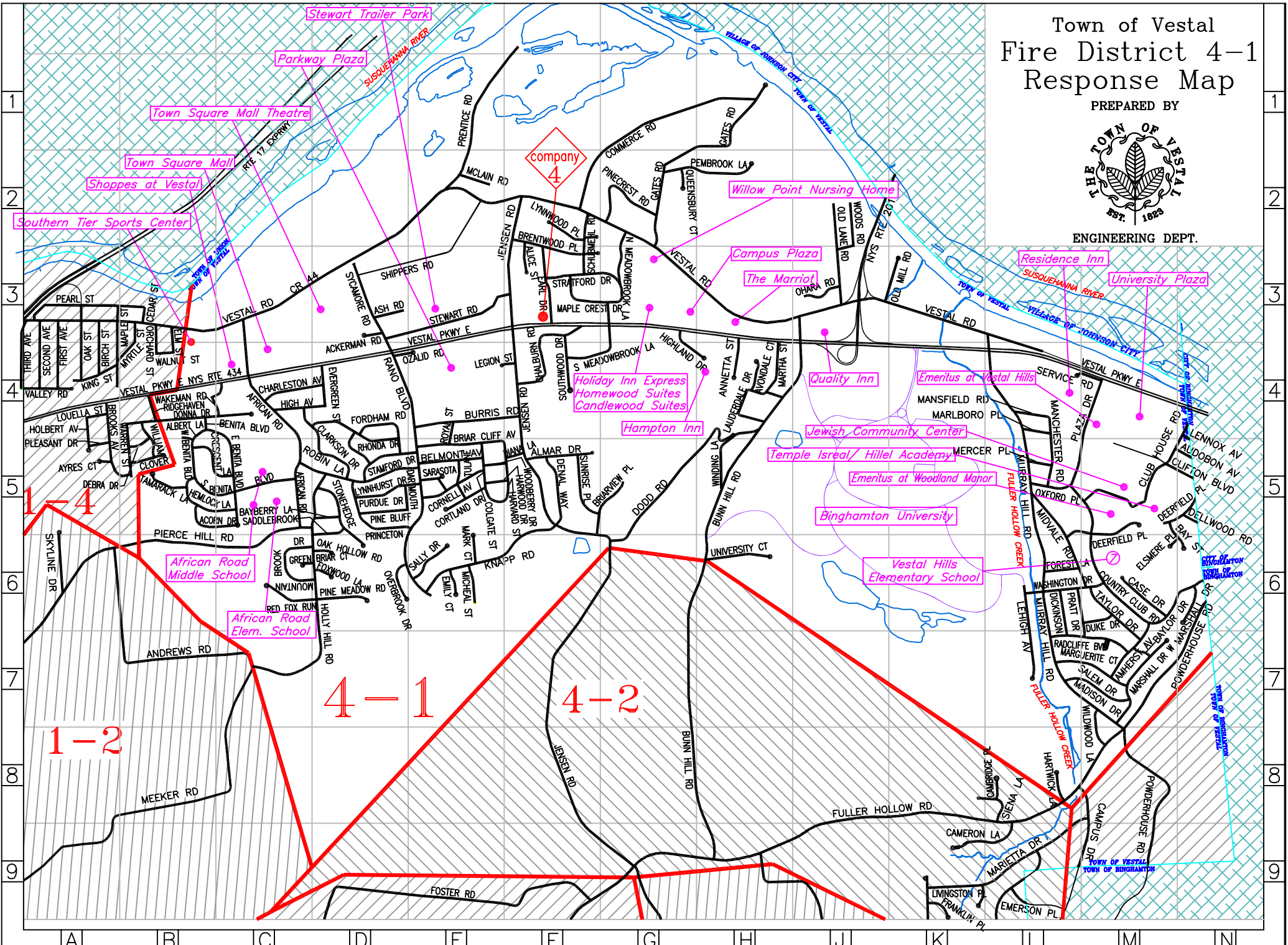

Company  
4

4-1

4-2

1-2

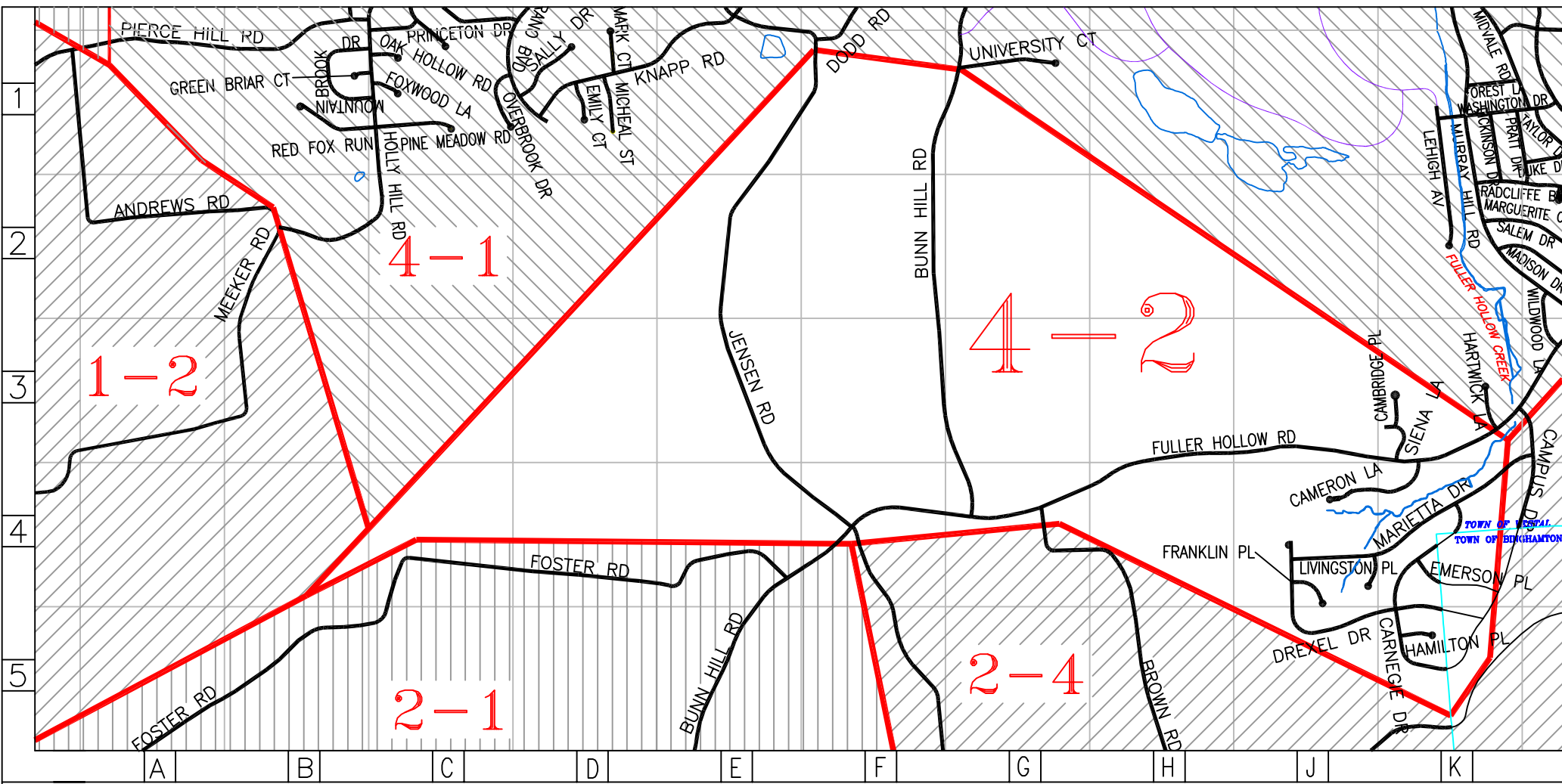

Town of Vestal  
 Fire District 4-2  
 Response Map



ANDREWS RD.	A 2	FULLER HOLLOW RD.	H 9	MURRAY HILL RD.	K 1
BROWN RD.	H 5	GREEN BRIAR CT.	B 1	OAK HOLLOW RD.	C 1
BUNN HILL RD. E.	E 5	HAMILTON PL.	K 5	OVERBROOK DR.	C 1
CAMBRIDGE PL.	K 3	HARTWICK DR.	K 3	PIERCE HILL RD.	A 1
CAMERON LA.	K 4	HOLLY HILL RD.	C 2	PINE MEADOW LA.	C 1
CAMPUS DR.	K 4	JENSEN RD.	E 3	PRATT DR.	K 1
CARNEGIE DR.	K 5	KNAPP RD.	D 1	PRINCETON DR.	C 1
DICKINSON DR.	K 1	LEHIGH AVE.	K 1	RADCLIFF BVLD.	K 2
DODD RD.	F 1	LIVINGSTON PL.	J 4	RANO BVLD.	D 1
DREXEL DR.	J 5	MADISON DR.	K 2	RED FOX LA.	B 1
DUKE DR.	K 1	MARGUERITE CT.	K 2	SALEM DR.	K 2
EMERSON PL.	K 4	MARIETTA DR.	K 4	SALLY DR.	D 1
EMILY CT.	D 1	MARK CT.	D 1	SIENA LA.	K 3
FOREST LA.	K 1	MEEKER RD.	B 3	TAYLOR DR.	K 1
FOSTER RD.	D 4	MICHAEL ST.	D 1	UNIVERSITY CT.	G 1
FOXWOOD LA.	C 1	MIDVALE RD.	K 1	WASHINGTON DR.	K 1
FRANKLIN PL.	J 4	MOUNTAIN BROOK DR.	B 1	WILDWOOD LA.	K 2

# BINGHAMTON UNIVERSITY

STATE UNIVERSITY OF NEW YORK

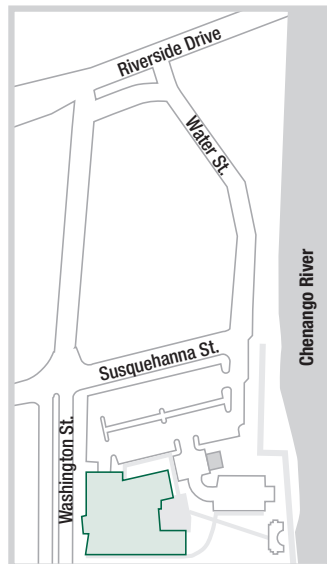
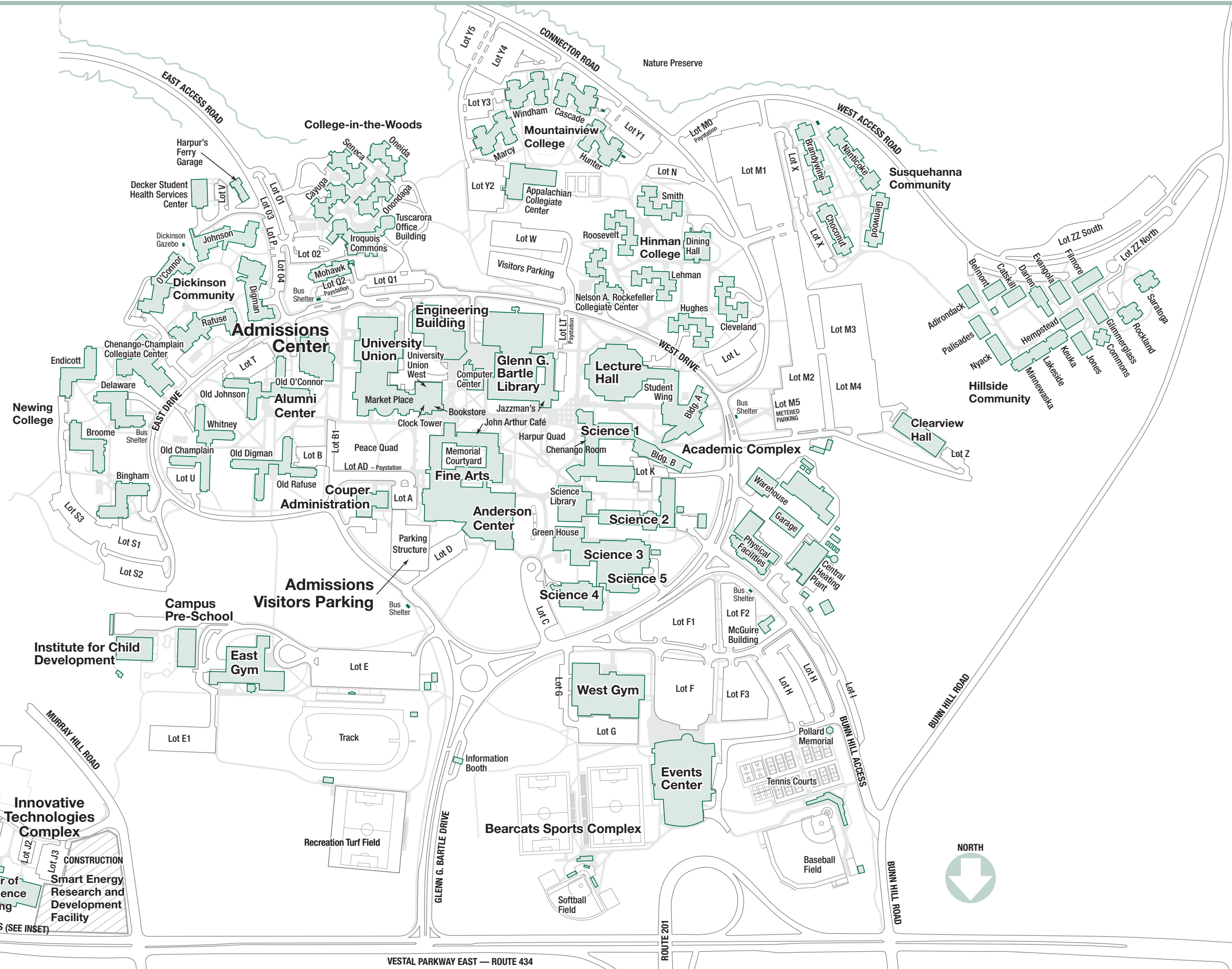

**University Downtown Center**  
67 Washington St., Binghamton

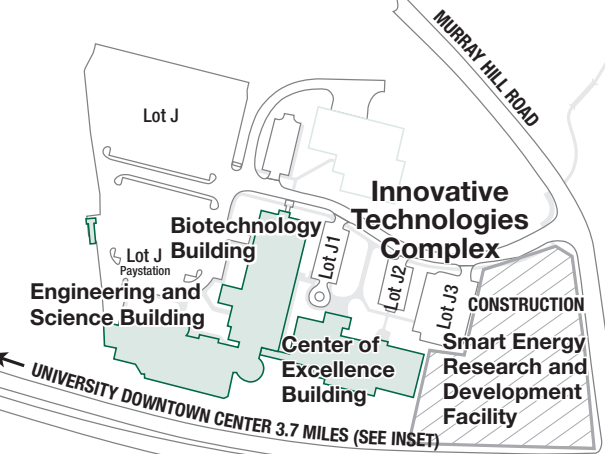

**Innovative Technologies Complex**  
UNIVERSITY DOWNTOWN CENTER 3.7 MILES (SEE INSET)

